

EZNTW-WI-EN902-aaa-b-cc-ddd-eee

OPTION-2 – EZNTW LOADED– ALL
OPTIONS – OLD TSTAT REPLACEMENT

- DEMAND ENABLEMENT
- DEMAND RESPONSE
- DYNAMIC DEMAND
- KW LOAD MANAGEMENT
- SOFT START
- OPTIMUM START – STOP
- ELECTRIC METERING
- BTU CALCULATION
- TIME SCHEDULE CONTROL
- OCCUPIED / UNOCCUPIED
- SECURITY (motion alerts)

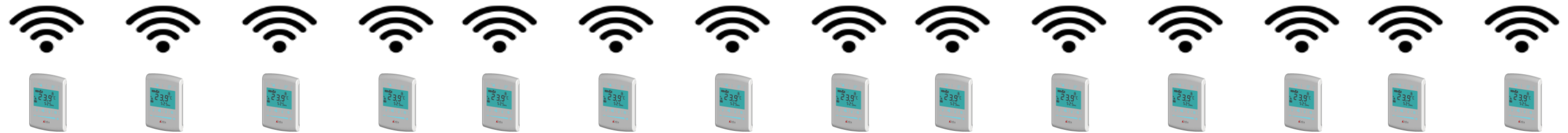

Each Controller pictured above represents an Apartment, Hotel Room, Single Family Home, Condo, Office Suite, Etc

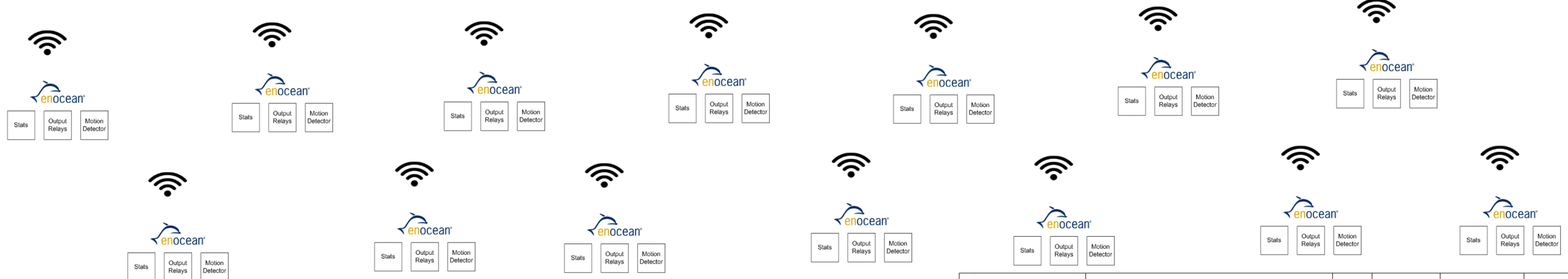

(Not to scale – FOR REFERENCE ONLY)

 561 ACORN STREET SUITE H DEER PARK, NEW YORK 11729 PHONE: 631.254.0573 FAX: 631.254.0597	Project: PEPCO WiFi w/ ENOCEAN Wireless	Edition: 1	Date: 4/02/2018	Description: PEPCO	Drawn by: CRS
	Sheet Name: EZNTW LAYOUT 6-1-18.VSD				
	Sheet Number: 2 of 4				

EZNTW-WI-EN902-aaa-b-cc-ddd-eee

OPTION-1 – BURY EZNTW – NO OPTIONS –
USE ENOCEAN FOR ALL LOCAL
APARTMENT SENSORS

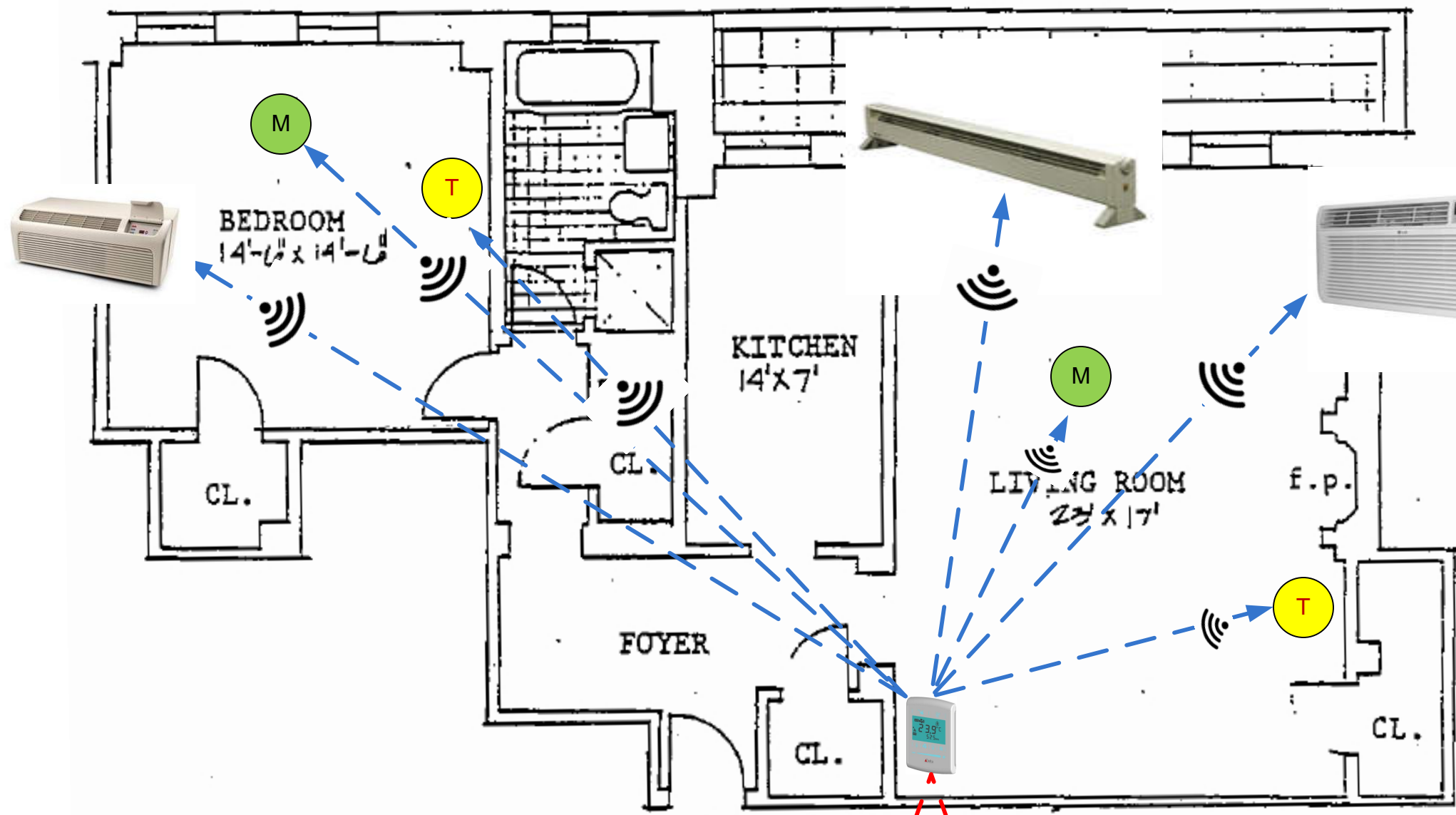

- PTAC or WINDOW A/C UNIT
- EN-902 Motion Detector
- EN-902 Tstat

- WIFI** NETWORK TO EMS/BAS
- EN-902** NETWORK TO APARTMENT SENSORS

- eZNTW-Wi-En902-B-SM-003-BBB enteliZONE Stat (RGB, Tmp, 10k, Prog, EnOcean902, Wifi)
- ERM-DL Wirelessly Controlled Relay

(Not to scale – FOR REFERENCE ONLY)

WWW



PEPCO
561 ACORN STREET
SUITE H
DEER PARK, NEW YORK 11729
PHONE: 631.254.0573
FAX: 631.254.0597

Project: PEPCO WiFi w/ ENOCEAN Wireless	Edition: 1	Date: 4/02/2018	Description: PEPCO	Drawn by: CRS
Sheet Name: EZNTW LAYOUT 6-1-18.VSD				
Sheet Number: 3 of 4				

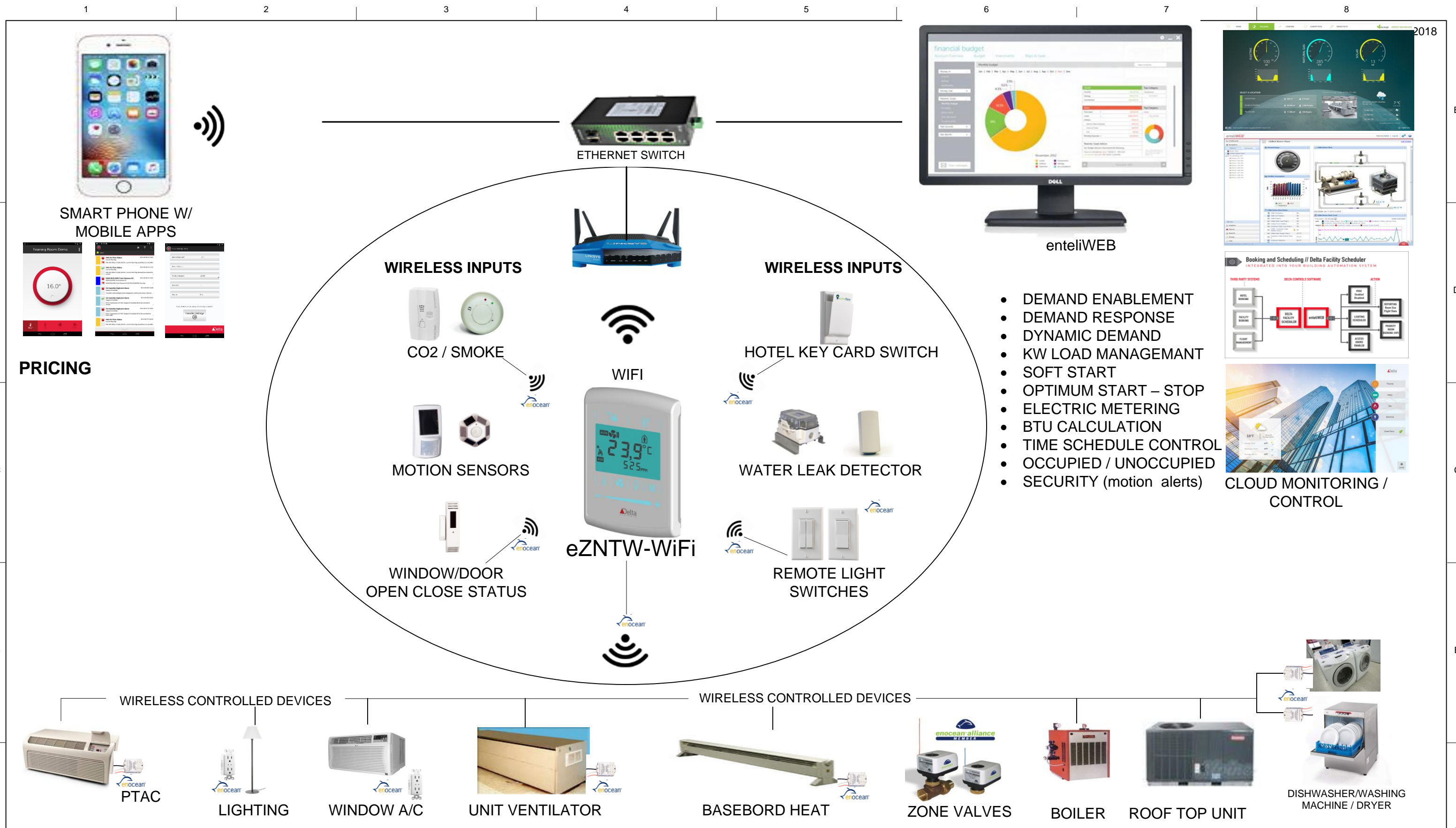

PRICING

- DEMAND ENABLEMENT
- DEMAND RESPONSE
- DYNAMIC DEMAND
- KW LOAD MANAGEMENT
- SOFT START
- OPTIMUM START – STOP
- ELECTRIC METERING
- BTU CALCULATION
- TIME SCHEDULE CONTROL
- OCCUPIED / UNOCCUPIED
- SECURITY (motion alerts)

NOTES:

- Prices above excludes taxes, installation or enrollment in any DR enablement or DR response program.
- Building must have suitable WiFi for web connection. PEPCO will provide WiFi at additional cost if WiFi does not exist.
- PEPCO Includes 1 year internet subscription w/alarms. Subscription fees after 1 year depend on system size.
- PEPCO will provide secure password and username to owner for remote access and control.
- PEPCO will file for UTILITY Rebate on behalf of customer. Price to file rebate will depend on size and complexity.



Project: PEPCO WiFi w/ ENOCEAN Wireless	Edition: 1	Date: 4/02/2018	Description: PEPCO	Drawn by: CRS
Sheet Name: EZNTW LAYOUT 6-1-18.VSD				
Sheet Number: 4 of 4				